

Meet the Sienna



QUICK POSSESSION HOME IN EDMONTON
472 EDMONTON DRIVE NW EDMONTON, ALBERTA



LANE COLLECTION

1636 SQ. FT.



This home's interior palette is the following:



LVP: Montreal



Cabinets: True White

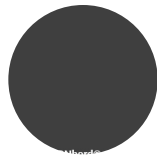

Island Cabinet: Charcoal



Backsplash: Dark Grey Glossy

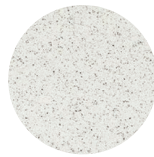

Quartz Countertops: Flint



Carpet: Walking Trail



Paint: Summit

This home features the following:

- Main floor bedroom and full bathroom
- Level 1 kitchen
- Level 2 lighting
- Exterior side entry to basement
- Rough-in for one bedroom legal suite

Standard features:

- BUILT GREEN® certified home
- Stainless steel appliances
- Thermally fused laminate cabinets
- Luxury vinyl plank throughout entire main floor and second floor wet areas
- Please see your Area Manager for the complete list of standard features

You can purchase this home for:



including home, lot and GST

Home availability:



For more information:



Anabela daPonte-Cordeiro
EDGEMONT AREA MANAGER

T: 780-278-9143
E: edgemont@excelhomes.ca



Simplifying your journey home.

Meet the Sienna

QUICK POSSESSION HOME IN EDMONTON 472 EDMONTON DRIVE NW

Floor plans

MAIN FLOOR
819 SQ.FT.

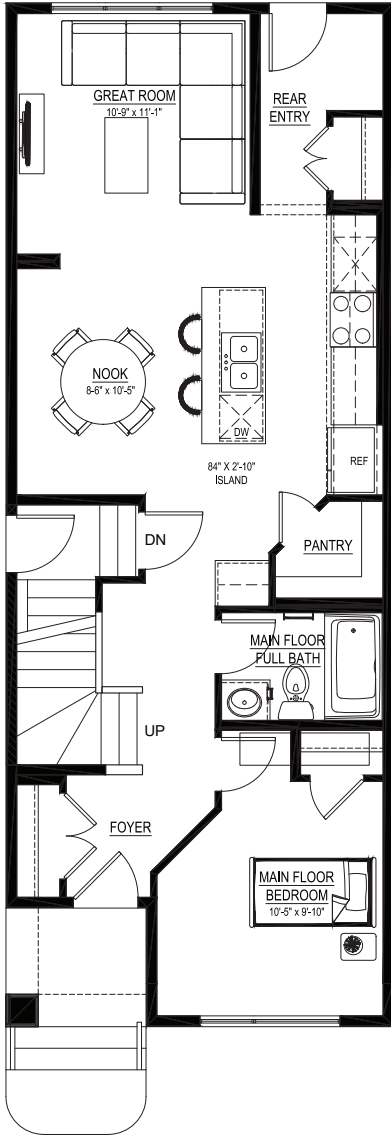

SECOND FLOOR
817 SQ.FT.

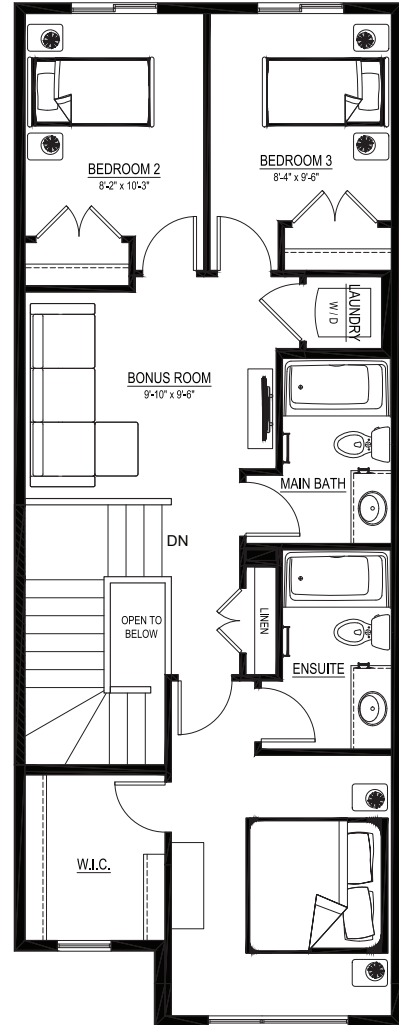

For more information.

Anabela daPonte-Cordeiro
EDMONTON AREA MANAGER

780-278-9143
EDMONTON@EXCELHOMES.CA

EXCELHOMES.CA